

beton C30/37, XD2, PV II  
armatura Bst 500S, Bst 500 M  
zaš. plast betona 4,0 cm

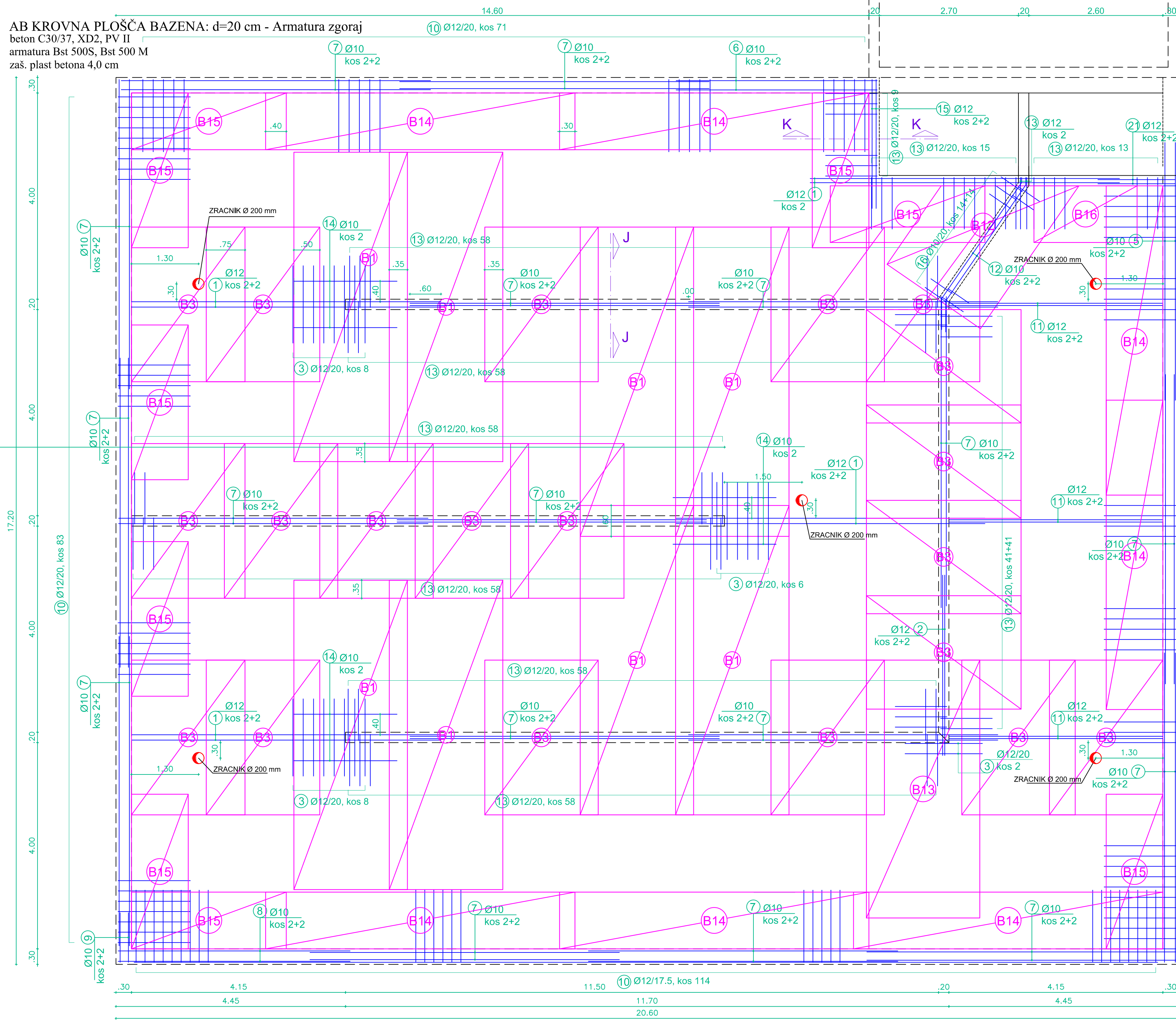

The drawing illustrates the reinforcement layout for a reinforced concrete slab (Q308) in a rectangular room. It includes plan views of the slab and a detailed section view.

**Plan Views:**

- Top Left Plan:** Shows a rectangular slab with overall dimensions 6.00m by 2.20m. A diagonal reinforcement bar is labeled B1. The slab is identified as Q636, kos 8.
- Top Right Plan:** Shows a rectangular slab with overall dimensions 6.00m by 1.40m. A diagonal reinforcement bar is labeled B12. The slab is identified as Q636, kos 1.
- Middle Left Plan:** Shows a rectangular slab with overall dimensions 6.00m by 2.20m. Two diagonal reinforcement bars are labeled B3. The slab is identified as Q636, kos 10.
- Middle Right Plan:** Shows a rectangular slab with overall dimensions 6.00m by 1.00m. A diagonal reinforcement bar is labeled B13. The slab is identified as Q636, kos 1.
- Bottom Left Plan:** Shows a rectangular slab with overall dimensions 6.00m by 2.20m. Four diagonal reinforcement bars are labeled B15. The slab is identified as Q308, kos 2.
- Bottom Right Plan:** Shows a rectangular slab with overall dimensions 6.00m by 1.00m. Two diagonal reinforcement bars are labeled B15 and B16. The slab is identified as Q308, kos 1.

**Section View (Bottom Right):**

- Shows a vertical section of the slab with a height of 6.00m.
- Two diagonal reinforcement bars are labeled B14.
- The slab is identified as Q308, kos 3.



**SEZNAM ARMATURE:**

Bar ID	Bar Type	Length (m)	Quantity
①	Ø12	6.0m	16
②	Ø12	3.50m	4
③	Ø12	1.0m	24
④	Ø12	1.5m	2
⑤	Ø10	5.0m	4
⑥	Ø10	3.50m	4
⑦	Ø10	6.0m	68
⑧	Ø10	4.50m	4
⑨	Ø10	1.00m	4
⑩	Ø12	1.75m	469
⑪	Ø10	2.0m	6
⑫	Ø12	2.50m	4
⑬	Ø10/20 cm	1.10m	28

- ① Ø12, l=6.0m, kos 16  
600
- ② Ø12, l=3.50m, kos 4  
350
- ③ Ø12, l=1.0m, kos 24  
100
- ④ Ø12, l=1.5m, kos 2  
150
- ⑤ Ø10, l=5.0m, kos 4  
500
- ⑥ Ø10, l=3.50m, kos 4  
350
- ⑦ Ø10, l=6.0m, kos 68  
600
- ⑧ Ø10, l=4.50m, kos 4  
450
- ⑨ Ø10, l=1.00m, kos 4  
100
- ⑩ Ø12, l=2.15m, kos 346  
140
- ⑪ Ø12, l=4.15m, kos 12  
415
- ⑫ Ø10, l=3.47m, kos 4  
346
- ⑬ Ø12, l=1.75m, kos 469  
100
- ⑭ Ø10, l=2.0m, kos 6  
200
- ⑮ Ø12, l=2.50m, kos 4  
250
- ⑯ Ø10/20 cm, l=1.10m, kos 28  
50

objekt VODOHRAN 1, (2, 3) AB KROVNA PLOŠĆA															
Brd 500 S															
				DOLŽINE PO $\phi$ (m)											
oznaka	$\phi$ mm	dužina m	kos	$\phi$ 8 m	$\phi$ 8 m	$\phi$ 10 m	$\phi$ 12 m	$\phi$ 14 m	$\phi$ 16 m	$\phi$ 20 m	$\phi$ 25 m	$\phi$ 28 m	$\phi$ 32 m	$\phi$ 40 m	
1	12	6,00	16				96,00								
2	12	3,60	4				14,40								
3	12	1,00	24				24,00								
4	12	1,90	2				3,00								
5	10	6,00	4			20,00									
6	10	3,50	4			14,00									
7	10	6,00	68			408,00									
8	10	4,50	4			18,00									
9	10	1,00	4			4,00									
10	12	2,10	4				8,80								
11	12	4,10	12				49,80								
12	10	3,47	4				13,88								
13	12	7,70	488				820,76								
14	10	2,50	6			12,00									
15	12	2,50	4				10,00								
16	10	1,10	28			33,80									
dolžina po $\phi$ m					0,00	0,00	520,68	1.026,15	0,00	0,00	0,00	0,00	0,00	0,00	
TEZA po AB-ovito dolžine				kg/m	0,222	0,369	0,688	1,210	1,500	2,470	3,850	4,830	5,310	5,980	
TEZA Po $\phi$				kg	0,00	0,00	321,26	619,22	0,00	0,00	0,00	0,00	0,00	0,00	
TEZA Po $\phi$ 8 m i na $\phi$ 14				kg			1.232,48				0,00				
TEZA SKUPAJ ZA VODOHRAN				kg				1.232,48							
TEZA SKUPAJ ZA TRI VODOHRANE				kg				3.697,44							
				ušina distančne kače (cm)											
ušina				kos	8	10	12	14	16	18	20				
20				240							216,24				
teža				kg/kos	0,560	0,587	0,615	0,765	0,809	0,855	0,901				
TEZA SKUPAJ ZA TRI VODOHRAN				kg				0,616	0,765	0,816	0,864				
TEZA SKUPAJ ZA TRI VODOHRANE				kg				648,72							

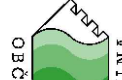
objekt: VODOHRANJE 1, (2, 3)								
POZICIJA: AB KROVNA PLOŠČA - armatura zgoraj								
Bst 500 M								
PODATKI O MREŽI								
oznaka	tip Q	kg/kos	kg/m2	dot12na	skupaj kosov	skupaj teža	klasifikacij	kg
Q 308	64,55	4,89	6,00	6	387,29	3,5 kg/m2		3,79
Q 336	131,74	9,98	6,00	20	2.634,72	16,5 kg/m2		2.634,72
SKUPAJ kg								3.022,01
SKUPAJ ZA 1 VODOHRANJE						kg		3.022,01
SKUPAJ ZA TRI VODOHRANJE						kg		9.066,02

		<b>OBČINA AJDOVŠČINA</b> , Cesta 5. maja 6a, 5270 Ajdovščina	
 <b>DETALJ</b> INFRASTRUKTURA		Detajl infrastruktura d.o.o. Na prodaj 13 5271 Vipava Slovenija	T 05 36 550 12 F 05 36 550 14 E info@detajl.si www.detajl.si
		<b>HIDRAVLICNE IZBOLJŠAVE</b> <b>VODOVODNEGA SISTEMA</b> <b>HUBELJ - VH IZVIR HUBLJA</b>	
	ime in priimek - naziv	id. št. IZS	Vrsta in št. načrta:
Vodja projekta:	Mitja Lavrenčič dipl. inž. grad	G - 1642	Načrt/vsebina lista <b>VODOHRAN 1, 2 IN 3: ARMATURNI</b> <b>NAČRT KROVNE PLOŠČE BAZENA</b> <b>- ARMATURA ZGORAJ</b>
Pooblaščenec izvedbeni:	Mitja Lavrenčič dipl. inž. grad	G - 1642	
Izdajatelj:	Mitja Lavrenčič dipl. inž. grad	G - 1642	
Sodielavec:	dr. Marko Lavrenčič mag. inž. gr.		
Vrsta projekta:	št. projekta:	datum:	merilo:
PZI	18/51-1	april 2020	1:50
			Številka lista:
			29